

# “Escape from Boston”

## Event Packet

**Date:** Friday May 19<sup>th</sup> through Sunday May 21<sup>st</sup>

**Check-in/set-up:** Friday noon through midnight, Saturday 7-9am

All participants must be associated with a registered unit, and **each participant must print, complete, and sign a Liability Release form and bring it with them to the event** and turn it in at the registration table upon arrival. The form is attached to this mailing.

The address for the event is 5 Littles Lane, Newbury, Massachusetts. Spencer-Peirce-Little Farm (SPL Farm) is all the way down at the end of the long tree-lined driveway. However, when you arrive, if you are in the Colonial camp, you will see a sign on the right, part way down the drive, to pull off and park, and then walk to the registration table. Once you are checked in, you will be directed where to set up. If you are in the British camp, just drive straight down to the registration table at the end of the drive and check in there. Your camp is beyond there and you will be directed where to set up.

If you have any questions regarding the encampment or the area around the event, please feel free to call or text Steve Crosby at 617 877-2361 or email me at [croz1775@gmail.com](mailto:croz1775@gmail.com).

---

**T-Shirts** – We have a limited number of “Escape From Boston” T-shirts available at \$16 each. Proceeds will go directly to the Farm to help defray the costs of hosting the event. If you want a t-shirt reserved, please reply to Steve at [croz1775@gmail.com](mailto:croz1775@gmail.com) and specify size. You will be expected to pay for, and receive, the shirt upon check-in at the registration table. Otherwise, your reserved shirt will go back up for grabs. The shirts are available in a cream color in all different sizes (adult S up to 3XL), and we have a few ladies shirts in pink (S,M,L), and children’s sizes in light gray.



## **AMENITIES AND DETAILS:**

**Wood** – we have 2-1/2 cord of wood available for the event. We have all seen units hoard firewood at other events, but we know nobody will do that here because we have plenty!

**Water** – will be provided from a manifold near the barns and will be a continuous supply

**Hay** – approximately 25 bales of hay will be available for bedding or whatever you need it for. In addition, there will be a few bales available for any horses that show up, compliments of SPL Farm

**Bathrooms** – There will be public bathrooms available from 9am to 5pm, and 14 Porta-Johns will be available throughout the weekend, which will be cleaned regularly

**Trash** – there is a dumpster onsite to dump trash into anytime you want

**Fresh air and open space** – You're on the northern coast of Massachusetts! Be sure to breathe deeply and enjoy this fine site while you're here!

**Ice** – available at local convenience stores, and we will try to take ice orders on Saturday morning and have some delivered right to the event by a local ice company

**House Tours** – The fine manor house on the property dates to the 17<sup>th</sup> century and has ties to the American Revolution. The barn on the property was built in 1775 – the actual year we are portraying! Tours of the house will be given all day, Friday through Sunday, free to reenactors

**Modern food vendor** – there will be a local vendor selling burgers during the day at the event

**Beer** – Ipswich Ale will be selling some of their fine selections to the public from their tap truck during the event. In the evening, we will be having a fine tavern and Ipswich will provide us with 2 fresh wooden casks with gravity taps. Makes you want to cry!

**Mead** – 1634 Meadery will be selling to the public during the day, and will give small samples during our tavern tent and will sell glasses of mead at the tavern as well. He is a small vendor, and his product is very good. If you like mead, please make it worth his while to stay the evening with us and buy a glass or two.

**Alcohol** - Ipswich Ale and 1634 Meadery are responsible for the liquor permit for the entire event, which means that technically they are the only ones allowed to serve alcohol. If they see anyone drinking openly anything other than Ipswich and 1634, they will have to confiscate your booze, so make sure they can't see you drinking openly anything other than the Ipswich Ale and 1634 mead. One consolation is that it is very dark at night, especially inside the tavern tent and around campfires. Be discreet please.

**Sutlers** – we have 5 sutlers setting up in the courtyard in front of the main house (Bethlehem Trading Co., Royal Blue Traders, Tory Tailor, Najecki's Reproductions, and PJS Trading)

**Parking** – Reenactor parking is at the adjacent farm, just beyond the American camp, and an easy walk back across the field (2 minutes). Camper and RV parking will also be in this area (see map). Handicap parking for both reenactors and spectators will be in the spectator parking area, which is central to the event and property.

## LOCAL AREA:

### **Groceries –**

- **Shaw's** and **Market Basket** are side by side full-scale supermarkets and are 3 miles away from the Farm.
- **Tendercrop Farm** is a local farm market almost across the street from SPL Farm and has fresh produce, meats, bread, and most other food supplies. Also has ice.
- **The Butchery** is - you guessed it – a butcher shop ¼ mile away. Also has some produce and bread and dairy and other staples, but mostly meats. Also has ice.
- There are numerous other Convenience stores, and beer and liquor stores within a mile to 3 miles radius of the event. In Massachusetts, beer, wine, and liquor are all sold in the same store.

**Restaurants and Pubs** – (Consider heading into Newburyport for dinner on Friday after setting up camp – it has many fine restaurants and pubs)

### **2 restaurants are offering a 10% discount to all reenactors in their colonial clothes or uniforms:**

- **The Grog** – (13 Middle Street Newburyport) The Grog is a local legend, offering common fare since the Civil War. Great, hometown atmosphere with good food and drink. **10% off if you are in colonial clothes or uniform** [\(978\) 465-8008](#)
- **Oregano** – (16 Pleasant Street Newburyport) An upscale Mediterranean pizza and specialty restaurant with amazing dishes and a nice warm atmosphere. Has outside seating too for warm evenings. **10% off if you are in colonial clothes or uniform** [\(978\) 462-5013](#)

---

### OTHER GREAT RESTAURANTS IN THE AREA (all within a mile of the event)

- **The Poynt** – great food and cocktails served in a stylish restaurant with a patio & TVs at the bar.
- **Brick and Ash** – upscale bar and restaurant with pool tables upstairs
- **Loretta** – one of the best burgers in town, it's an upscale restaurant and bar with great food
- **The Black Cow** – upscale dining right on the waterfront, with outside waterfront dining.
- **Michael's Harborside** – great seafood and bar right on the water. Upstairs bar is outside. Great view.
- **Brine** – Upscale oyster bar and fresh seafood on Newburyport's main street (State St.)
- **Brown Sugar by the Sea** – Thai restaurant and bar with great food and atmosphere
- **Glenn's** – Cozy, art-adorned space featuring eclectic entrees & tapas
- **Ceia** - European coastal eatery offering seasonal ingredients & large wine list in a modern space.
- **Starboard Galley** – Fried and broiled seafood in a rustic setting
- **Bob Lobster** – a rustic lobster and seafood place out on the marshes with the best lobster roll around! Sit inside or under the umbrellas. You could walk there from the event. Great for lunch on Friday after you set up camp.
- **Plum Island Grille** – restaurant out on the marshes with the best sunsets anywhere! Great food and drinks.
- **The Port Tavern** – a great Irish pub/sports bar with fantastic burgers and pub fare
- **Andiamo** – Italian cuisine in a nice quaint atmosphere
- **Mr. India** – Fine Indian cuisine
- **Jewel in the Crown** – Fine Indian cuisine off the beaten path
- **Mission Oak** – Fine upscale restaurant in a big old converted church
- **The Park Lunch** – a legend in town, this place burned to the ground but came back from the ashes. Burgers, pasta dishes, seafood, and everything you can think of in a solid rustic atmosphere
- **Agave** – great Mexican cuisine in an upscale atmosphere on 3 levels with 2 great bars

Newburyport has literally 14 different pizza restaurants, and numerous other sandwich/ burrito /coffee and specialty restaurants to check out.

**LOCAL LODGING:**

If you don't want to camp or you have folks coming to watch the event who want to stay locally, there are plenty of inns and B&B's in the area.

Garrison Inn – [www.garrisoninn.com](http://www.garrisoninn.com) – (978) 499-8500

Essex Street Inn – [www.essexstreetinn.com](http://www.essexstreetinn.com) - (978) 465-3148

The Compass Rose Inn - [www.compassrosenewburyport.com](http://www.compassrosenewburyport.com) - (978) 675-6660

The Clark Carrier Inn – [www.clarkcurrierinn.com](http://www.clarkcurrierinn.com) - (978) 465-8363

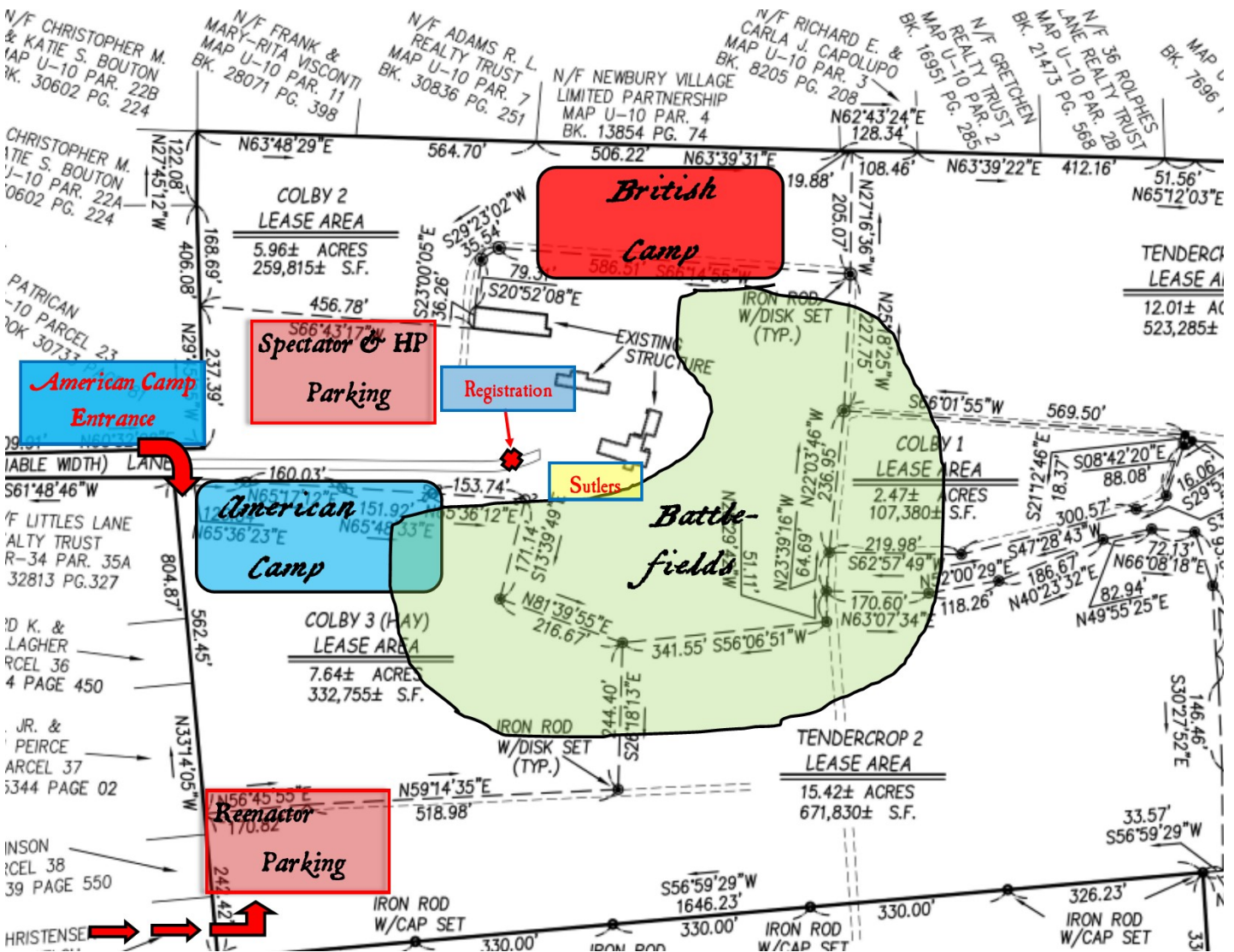

## ESCAPE FROM BOSTON WEEKEND SCHEDULE

### Friday, May 19<sup>th</sup>

1200 - 2400 hrs: Site open for camp set-up

### Saturday, May 20<sup>th</sup>

0700 hrs: Morning gun / Reveille

0700 hrs: Site open for camp set-up

0800 hrs: Officer's Call

0830 hrs: Serjeant's Call

0900 hrs: All vehicles must be out of camp

0915 hrs: Individual Regimental-Company Formations & Inspections

1000 hrs: Site opens to public

1000 hrs: Maintain 18th century appearance, Regimental-Company Drills / Interact with public

1015 hrs: Army Formations

1130 hrs: Presentation; "*General Ward's Colonial Army*" by Keith Brough

1200 hrs: Noonning

1315 hrs: Army Formations for Battle Scenario

1330 hrs: Battle Scenario Begins

1430 hrs: Battle Scenario Ends

1515 hrs: Last Man Standing Competition

1600 hrs: Cricket Match

1700 hrs: Site closes to the public

2000 hrs: Tavern begins

2300 hrs: "Quiet Time"

### Sunday, May 21<sup>st</sup>

0700 hrs: Morning gun / Reveille

0700 hrs: Site open for day-trip arrivals

0800 hrs: Officer's Call

0830 hrs: Serjeant's Call

0900 hrs: All vehicles must be out of camp

0915 hrs: Individual Regimental-Company Formations & Inspections

0930 hrs: Church Parade

1000 hrs: Site opens to public

1000 hrs: Maintain 18th century appearance, Regimental-Company Drills / Interact with public

1115 hrs: Army Formations for Battle Scenario

1130 hrs: Battle Scenario Begins

1230 hrs: Battle Scenario Ends

1230 hrs: Noonning

1300 hrs: "Old-time" Baseball League

1300 hrs: Interact with public

1330 hrs: Participants may begin to break camp

1700 hrs: Site closes to the public



*Escape from Boston*  
*Spencer-Peirce-Little Farm*  
 May 19 - 21, 2017



**Release from Liability**

In consideration of my participation in the military and/or historical re-enactments known as "Escape From Boston" hosted by *The Acton Minutemen/Simon Hunt's Co.* and *His Majesty's Tenth Regiment of Foot, in America*, hereby collectively known as the "**host regiments**," on the premises of Spencer-Pierce-Little Farm in Newbury, MA (**SPL Farm**) (owned and operated by Historic New England) on May 19-21, 2017, the receipt and adequacy of which is hereby acknowledged, the undersigned does hereby release the **host regiments**, **SPL Farm**, their respective agents, officers, directors, employees, members and volunteers, and any and all subordinate or affiliated organizations or persons sponsoring, hosting or associated with such activity, from any and all liability, claims, demands, actions and causes of action whatsoever, arising out of or related to any loss, damage or injury, including death, that may be sustained by me or my property while in or on such premises and/or while participating in such activity.

I am duly aware of the risks and hazards inherent in entering said premises, and/or enroute to or from the same, and in participating in such activities. I hereby voluntarily elect to enter said premises and/or participate in such activities knowing the present condition and intended use of said premises, and knowing that the condition and/or use thereof may become hazardous during the time I am upon said premises. I assume all risks, whether or not disclosed, including without limitation the risk of loss, damage, injury or death, which may be sustained by me, or to my property, while upon said premises or enroute to or from the same. This release shall be binding upon me as well as my distributees, heirs, next of kin, executors and administrators.

In signing the foregoing, I hereby acknowledge that I have read this release, understand it, and sign it voluntarily. If the parent or guardian of a minor child who is participating and who is named below, I also hereby sign on his/her behalf and I represent that I have full legal authority to do so.

Print your name: \_\_\_\_\_

Address: \_\_\_\_\_

Fielding Unit: \_\_\_\_\_

Emergency Contact information: \_\_\_\_\_

Emergency Contact phone #: \_\_\_\_\_

Signed: \_\_\_\_\_ Date: \_\_\_\_\_

***Parent/guardian signature required if above named person is a minor:***

Print parent/guardian name: \_\_\_\_\_

Relationship to above named person: \_\_\_\_\_

Parent/guardian signature: \_\_\_\_\_ Date: \_\_\_\_\_